

Machine Screws

Head Dimensions

82° Flat
100° Flat

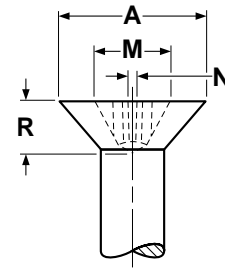
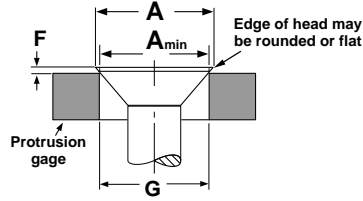
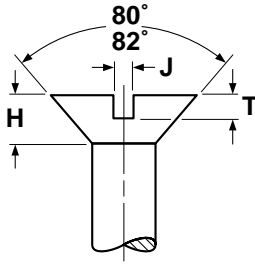

FLAT HEADS FOR MACHINE SCREWS

ANSI B18.6.3

Nominal Size	A		H		J		T		M		G	N	Phillips Driver Size
	Head Diameter		Height of Head		Width of Slot		Depth of Slot		Dimensions of Recess				
	Max	Min	Max	Min	Max	Min	Max	Min	Max	Min	Max	Min	
0	.119	.099	.035	.026	.023	.016	.015	.010	.069	.056	.043	.014	0
1	.146	.123	.043	.033	.026	.019	.019	.012	.077	.064	.051	.015	0
2	.172	.147	.051	.040	.031	.023	.023	.015	.102	.089	.063	.017	1
3	.199	.171	.059	.047	.035	.027	.027	.017	.107	.094	.068	.018	1
4	.225	.195	.067	.055	.039	.031	.030	.020	.128	.115	.089	.018	1
5	.252	.220	.075	.062	.043	.035	.034	.022	.154	.141	.086	.027	2
6	.279	.244	.083	.069	.048	.039	.038	.024	.174	.161	.106	.029	2
8	.332	.292	.100	.084	.054	.045	.045	.029	.189	.176	.121	.030	2
10	.385	.340	.116	.098	.060	.050	.053	.034	.204	.191	.136	.032	2
12	.438	.389	.132	.112	.067	.056	.060	.039	.268	.255	.156	.035	3
1/4	.507	.452	.153	.131	.075	.064	.070	.046	.283	.270	.171	.036	3
5/16	.635	.568	.191	.165	.084	.072	.088	.058	.365	.352	.216	.061	4
3/8	.762	.685	.230	.200	.094	.081	.106	.070	.393	.380	.245	.065	4
1/2	.875	.775	.223	.186	.106	.091	.103	.065	.424	.411	.276	.069	4

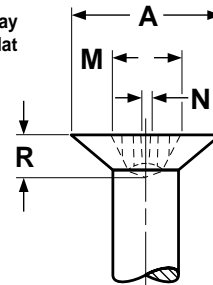
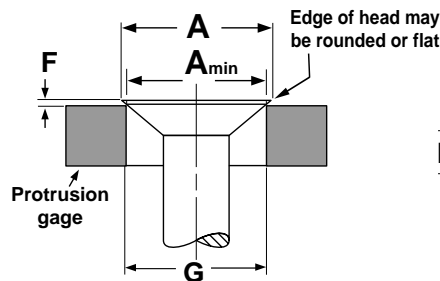
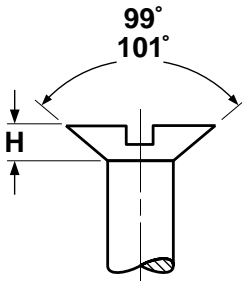

FLAT HEAD 100° FOR MACHINE SCREWS

ASME B18.6.3-1998

Nominal Size	A		H		J		T		M	R	N	F		G	Phillips Driver Size
	Head Dimensions		Slot Dimensions		Recess Dimensions			Protrusion Above Gaging Diameter		Gaging Diameter					
	Diameter		Height		Width		Depth		Diam.		Depth	Width	Max	Min	
	Max	Min	Max	Min	Max	Min	Max	Min	Ref	Ref	Ref	Max	Min		
0	.112	.095	.026	.019	.023	.016	.013	.008	.054	.027	.013	.020	.012	.074	0
2	.162	.142	.037	.029	.031	.023	.019	.012	.088	.048	.012	.022	.014	.121	1
4	.212	.188	.049	.039	.039	.031	.024	.017	.110	.070	.018	.025	.016	.167	1
6	.262	.235	.060	.049	.048	.039	.030	.022	.148	.074	.027	.028	.017	.214	2
8	.312	.282	.072	.060	.054	.045	.036	.027	.162	.090	.028	.031	.019	.261	2
10	.362	.329	.083	.070	.060	.050	.042	.031	.178	.104	.030	.034	.021	.307	2
1/4	.477	.437	.110	.094	.075	.064	.055	.042	.240	.124	.033	.040	.025	.415	3